

# Burlington House

Manchester, England

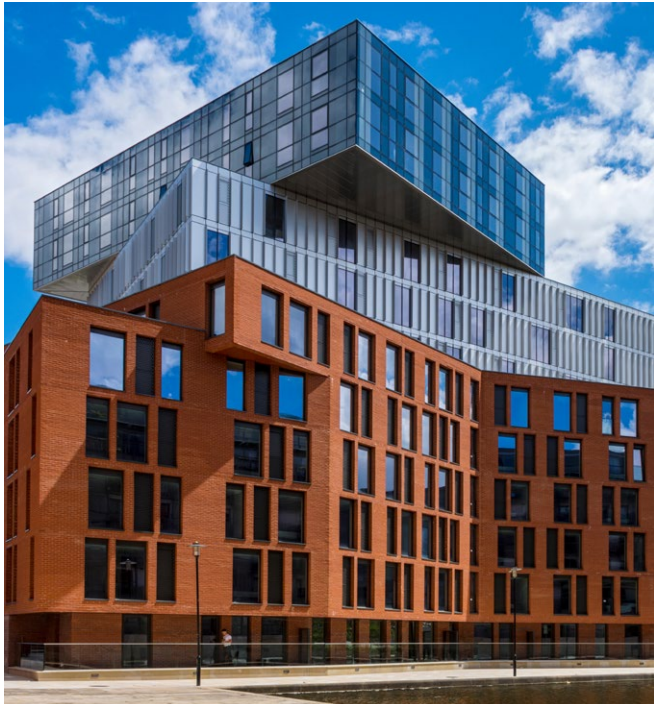

**Metal Technology Limited**  
Steeple Rd Industrial Estate | Steeple Road  
Antrim BT41 1AB | Northern Ireland  
T +44 (0)28 9448 777  
sales@metaltechnology.com  
metaltechnology.com

Follow us on  





# Burlington House

Manchester, England

## A striking façade on Manchester's most centrally located apartments

Burlington House is a highly complex city centre structure designed by renowned architects Simpson Haugh and Partners and is located in Manchester's Piccadilly Basin, reinforcing its links with the vibrant Northern Quarter. The 11-storey statement building built by GMI Construction has 91 apartments and required close consultation with English Heritage and the Canal Rivers Trust as it abuts the Grade 2 listed Jackson's Warehouse and completes the enclosure of the Piccadilly Marina.

A striking upper construction of a simple box balancing over the two structures below, orientates itself towards the city centre and is a visually lighter form composed of a flush glass curtain walling system which reflect the changing sky and becomes animated at dusk and night-time. Capitalising on the trend for contemporary city centre living, the design provides a mix of 1-bed, 2-bed and 3 bedroom apartments with a range of sizes to suit an expanding local market. These are primarily arranged to provide views of the canal and marina with south-westerly and south-easterly aspects. The site constraints provided opportunities to create bespoke plan types that offer a unique product within the marketplace.

The architects have sensitively exploited the aesthetics and performance of Metal Technology's System 17 SP Curtain Walling with frameless concealed vents on the upper level and silver anodised System 17 Curtain Walling with a bespoke 180mm tapered cap on the second tier, System 5-35 tilt and turn windows with bespoke frame to suit the architects glazing requirements was also developed for the project which has been complimented with Metal Technology's System 5-20D Door System.

All Metal Technology's systems are designed to perform seamlessly together to deliver the desired aesthetic and performance standards. Used individually or together, they offer complete design flexibility for creative expression with the assurance of value engineered structural, weather and security performance.

### Client

Belgravia Living Group

### Architect

Simpson Haugh  
and Partners

### Main Contractor

GMI Construction

### Systems Used

System 5-20D

System 17 High Rise

System 17 SP

Silicone Pointed

System 5-35 Hi / Hi+

### Metal Technology Limited

Steeple Rd Industrial Estate | Steeple Road

Antrim BT41 1AB | Northern Ireland

T +44 (0)28 9448 777

sales@metaltechnology.com

metaltechnology.com

Follow us on

